

Raptor 60/90 Rotor Grip Instructions

Note: Add blue Loctite to all screws when assembling.

Step 1: Assemble the pitch arm by attaching EL0335-3 to EL0335-2 with the M3X10 cap screw. Attach the standard ball-link ball with the M2 machine screw.

Step 2: Assemble the pitch arm to the grip using two M3X8 cap screws. **Make sure both screws are in place before tightening. If one screw is tightened before the other one is in place, the arm will pull off center and the other hole will not line up.** Tighten screws with equal pressure.

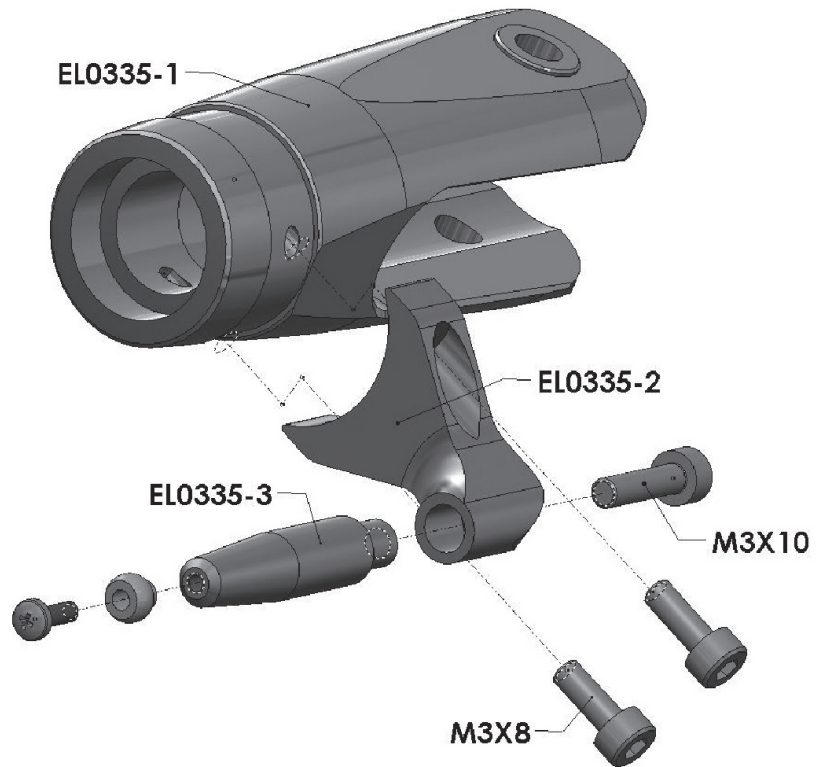

Step 3: Assemble the grip to the helicopter per the stock instruction manual. Add a small amount of blue or green Loctite to the bearing bores using a cotton swab before inserting the bearings. We recommend inserting the inner bearing first and using the spindle to keep the outer bearings aligned as they go in. Make sure the thrust bearing race with the smaller I.D. goes in last.

Note: If you cannot press the bearings into the grip by hand, warm the grip with a hair dryer, heat gun, or low temperature oven. Avoid pounding the bearings in as this will damage them.